

# UPTON COUNTRY PARK PLAY AND RECREATION ENHANCEMENTS

DECEMBER 2011

All locations and areas shown are  
indicative and for mapping purposes only.

## LEISURE SERVICES

Borough of Poole  
Leisure Services  
Northmead House  
30-32 Northmead Road  
Creekmoor  
Poole BH17 7RP

Tel No. 01202-265265  
Fax 01202-261342

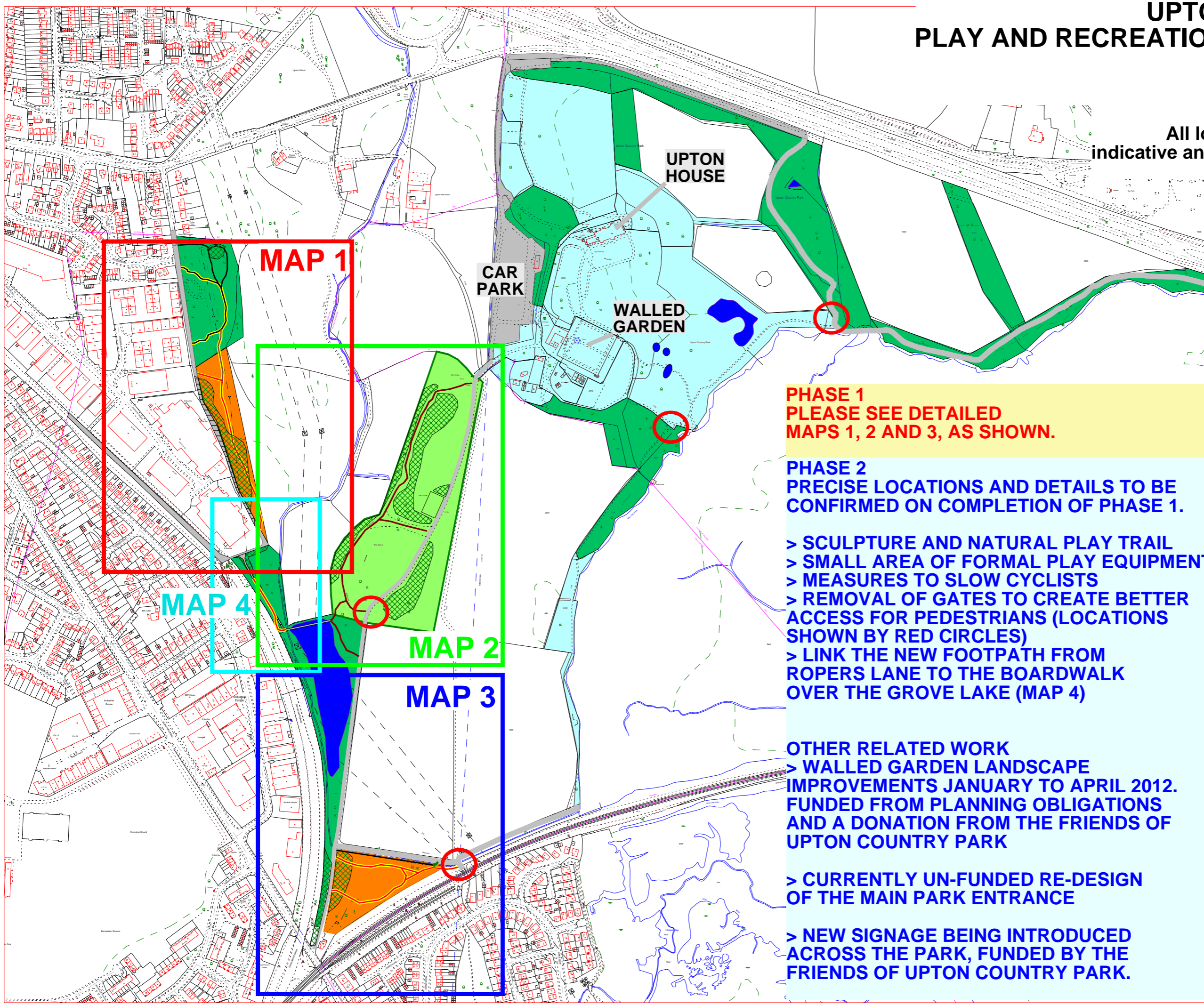
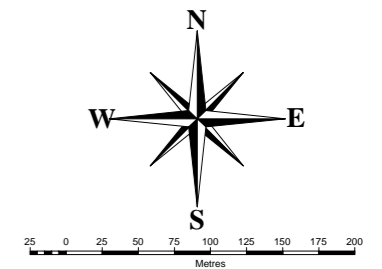

**PHASE 1**  
PLEASE SEE DETAILED  
MAPS 1, 2 AND 3, AS SHOWN.

**PHASE 2**  
PRECISE LOCATIONS AND DETAILS TO BE  
CONFIRMED ON COMPLETION OF PHASE 1.

- > SCULPTURE AND NATURAL PLAY TRAIL
- > SMALL AREA OF FORMAL PLAY EQUIPMENT
- > MEASURES TO SLOW CYCLISTS
- > REMOVAL OF GATES TO CREATE BETTER ACCESS FOR PEDESTRIANS (LOCATIONS SHOWN BY RED CIRCLES)
- > LINK THE NEW FOOTPATH FROM ROPERS LANE TO THE BOARDWALK OVER THE GROVE LAKE (MAP 4)

**OTHER RELATED WORK**  
> WALLED GARDEN LANDSCAPE IMPROVEMENTS JANUARY TO APRIL 2012. FUNDED FROM PLANNING OBLIGATIONS AND A DONATION FROM THE FRIENDS OF UPTON COUNTRY PARK

> CURRENTLY UN-FUNDED RE-DESIGN OF THE MAIN PARK ENTRANCE

> NEW SIGNAGE BEING INTRODUCED ACROSS THE PARK, FUNDED BY THE FRIENDS OF UPTON COUNTRY PARK.