

MAP 1 ROPERS LANE

REMOVAL OF LAUREL

CUTTING BACK OF EXISTING INFORMAL PATHS

CREATION OF A NEW INFORMAL PATH LINKING TO MEADOW STRIP

NO TREES FELLED UNLESS REQUIRED FOR SAFETY REASONS OVER PATHS

FOOTPATH CLEARED OF VEGETATION AND SURFACE IMPROVEMENTS TO BE MADE IF AFFORDABLE.

NEW PEDESTRIAN ENTRANCE

VEGETATION CLEARANCE NEAR THE ENTRANCE TO THE PARK.

ROPERS LANE WOODS

MEADOW STRIP

CREATION OF A NEW FOOTPATH

SELECTIVE CUTTING BACK OF MATURE GORSE AND TREES FOR HABITAT MANAGEMENT AND ACCESS.

NEW ENTRANCE TO FOOTPATH.

BARBED WIRE FENCE ON THE MEADOW SIDE OF THE FOOTPATH TO BE REMOVED WHERE POSSIBLE.

This map is reproduced from the Ordnance Survey with the permission of Ordnance Survey on behalf of the Controller of Her Majesty's Stationery Office. Crown Copyright. Unauthorised reproduction infringes Crown Copyright and may lead to prosecution or civil proceedings. 10024248, 2007

MAP 2 GROVE WOOD

THE GROVE WOOD WILL HAVE UNDERSTOREY VEGETATION SUCH AS RHODODENDRON AND LAUREL SELECTIVELY REMOVED (MAIN AREAS SHOWN HATCHED)

OVER TIME THIS WILL IMPROVE THE HABITAT OF THE WOODS, PROVIDE A MORE OPEN AND WELCOMING ENVIRONMENT AND ALLOW FURTHER ENHANCEMENTS.

NO TREES WILL BE FELLED UNLESS REQUIRED FOR SAFETY REASONS OVER PATHS

ONLY ONCE THE VEGETATION HAS BEEN CLEARED WILL A FULL ASSESSMENT BE MADE OF WHAT THESE ENHANCEMENTS WILL BE, BUT THEY ARE LIKELY TO INCLUDE:

- > USE OF NATURAL MATERIALS, LOGS, BOULDERS ETC TO ENCOURAGE NATURAL PLAY
- > NEW SIGNAGE TO RECOGNISE THE WOODS ARE AN APPROPRIATE PLACE TO LET DOGS EXERCISE OFF THE LEAD
- > INSTALLATION OF A DOG AGILITY TRAIL
- > NEW HEDGE PLANTED (EXACT LOCATION TO BE IDENTIFIED)
- > AREAS TO BE IDENTIFIED FOR BESPOKE TIMBER SEATING AND SCULPTURE
- > INFORMAL FOOTPATHS IMPROVED
- > MEASURES TAKEN TO SLOW CYCLISTS ON THE BEND OF THE MAIN TRACK

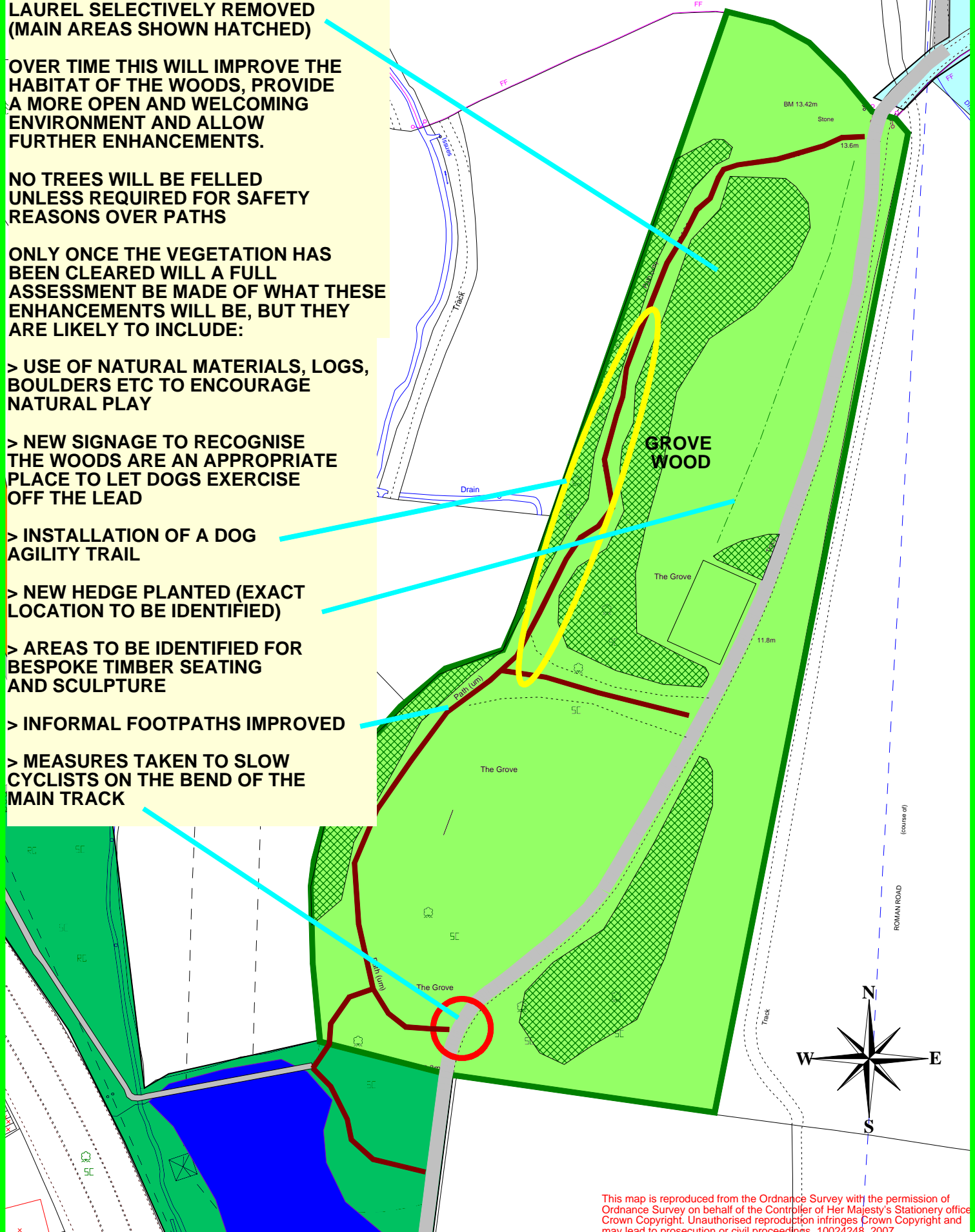

This map is reproduced from the Ordnance Survey with the permission of Ordnance Survey on behalf of the Controller of Her Majesty's Stationery Office Crown Copyright. Unauthorised reproduction infringes Crown Copyright and may lead to prosecution or civil proceedings. 10024248. 2007

**BOROUGH OF POOLE
LEISURE SERVICES
Greenspace Development Team**

**UPTON COUNTRY PARK
PLAY & RECREATION ENHANCEMENTS
SCALE:1:2000
DECEMBER 2011**

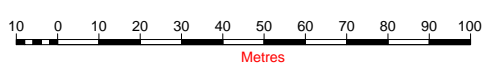

M Whitchurch

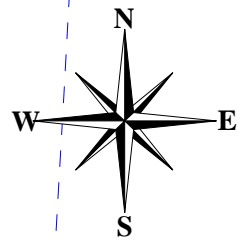

MAP 3 JACKS WOOD

REMOVAL OF FENCING AND CREATION OF A NEW INFORMAL PATH. ACCESS TO SYMES ROAD ENTRANCE TO BE DETERMINED

SELECTIVE CUTTING BACK OF LAUREL AND RHODODENDRON

NO TREES ARE TO BE FELLED UNLESS REQUIRED FOR SAFETY REASONS OVER PATHS

NEW POST AND RAIL FENCE INSTALLED TO THE TOP OF THE BANK

WIDER, MORE ACCESSIBLE AND WELCOMING ENTRANCE CREATED FROM BLANDFORD ROAD. REMOVAL OF EXISTING FENCE AND REPLACED WITH RAILINGS. NEW SIGNAGE.

This map is reproduced from the Ordnance Survey with the permission of Ordnance Survey on behalf of the Controller of Her Majesty's Stationery Office. Crown Copyright. Unauthorised reproduction infringes Crown Copyright and may lead to prosecution or civil proceedings. 10024248-2007

**BOROUGH OF POOLE
LEISURE SERVICES
Greenspace Development Team**

**UPTON COUNTRY PARK
PLAY & RECREATION ENHANCEMENTS
SCALE:1:2000
DECEMBER 2011**

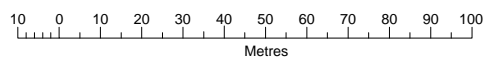

M Whitchurch

MAP 4 - PHASE 2 ROPERS LANE TO BOARDWALK LINK

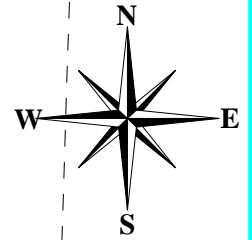

EXTEND SURFACING FROM NEW FOOTPATH ON TO UCP ENTRANCE

**NEW ENTRANCE FROM ROPERS LANE AND ALLENS ROAD PATHS.
CREATE IMPROVED ENTRANCE WITH NEW FENCING, SITE SIGNAGE AND SURFACING.
CUT BACK SURROUNDING VEGETATION**

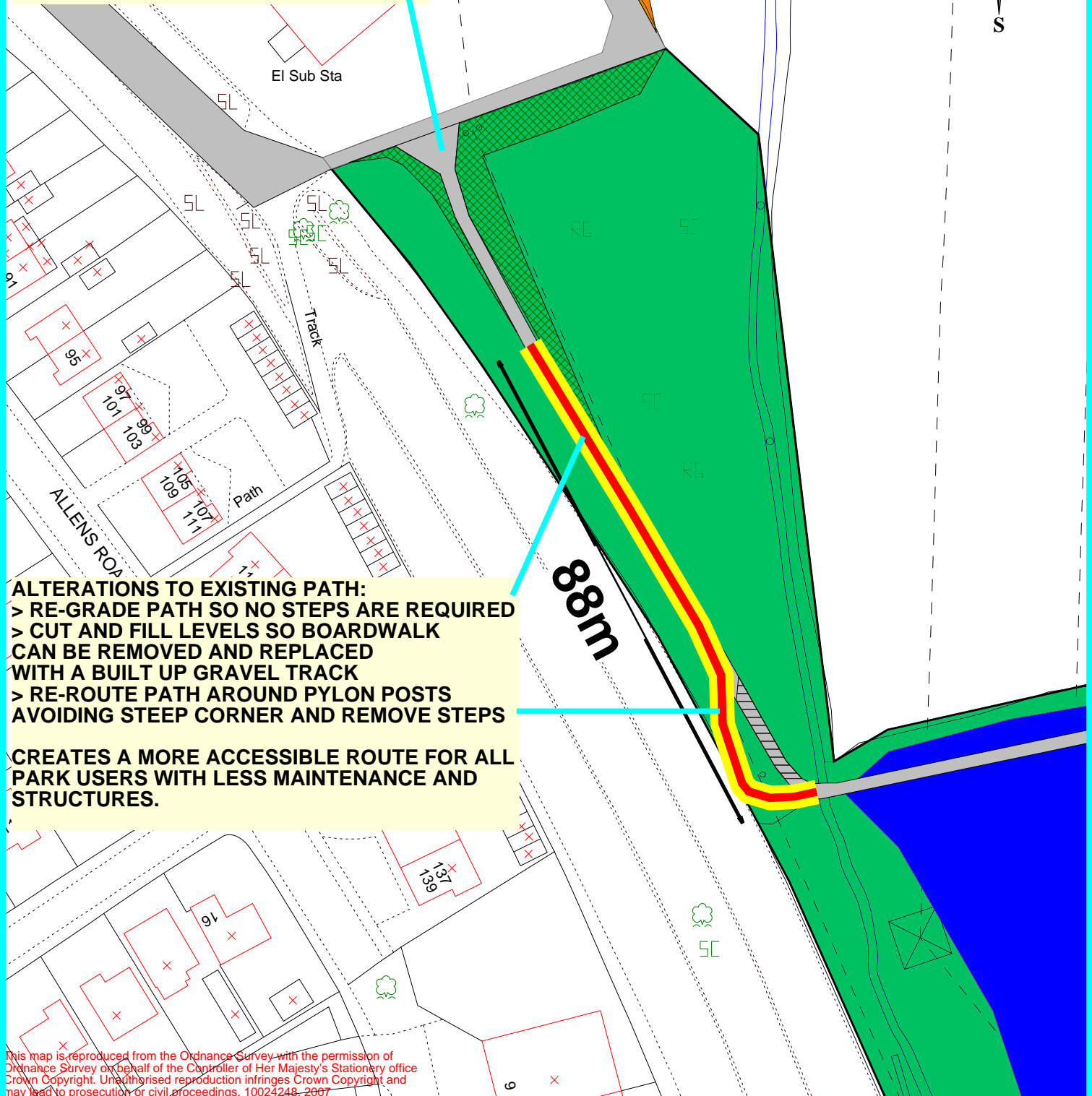

ALTERATIONS TO EXISTING PATH:
 > RE-GRADE PATH SO NO STEPS ARE REQUIRED
 > CUT AND FILL LEVELS SO BOARDWALK CAN BE REMOVED AND REPLACED WITH A BUILT UP GRAVEL TRACK
 > RE-ROUTE PATH AROUND PYLON POSTS AVOIDING STEEP CORNER AND REMOVE STEPS

CREATES A MORE ACCESSIBLE ROUTE FOR ALL PARK USERS WITH LESS MAINTENANCE AND STRUCTURES.

This map is reproduced from the Ordnance Survey with the permission of Ordnance Survey on behalf of the Controller of Her Majesty's Stationery Office Crown Copyright. Unauthorised reproduction infringes Crown Copyright and may lead to prosecution or civil proceedings. 10024248-2007

